



Move-In Checklist

Necessary Items

- Bath robe, shower shoes
- Shower Caddy
- Towels and Washcloths
- Twin-Sized Bedding (Comforter, sheets, pillowcases, blanket, mattress pad, etc. **Guys** - Some rooms in Tom Black Hall have *extra long* twin beds.)
- Alarm Clock
- Power Strips/ 3-Prong Adaptors
- Outdoor Approved Extension Cord
- Laundry Items (Detergent, Laundry Hamper, quarters for the machines, etc.)
- Emergency Kit (First Aid Kit, Batteries, Bottled Water, Flashlight, etc.)
- Paper Towels/Kleenex
- Clothes Hangers
- Room decorations, pictures of family and friends

Suggested Items

- Dorm-Size Refrigerator
- Small Microwave
- Throw Rug or Carpet Samples
- Extra twin-sized mattress (this will make your bed higher)
- TV/DVD/Stereo (Your room has an outlet for FREE cable TV.)
- Game System (PS3, Xbox, Wii, etc.)
- Laptop
- Fan
- Curtains
- Crates or Stacking Containers
- Lamps
- Mirror with Over-Door Hooks
- Plates, Mugs, Silverware, etc.
- Bike
- School Supplies
- Basic Cleaning Supplies

Items to Leave at Home

- Candles/Incense
- Hot Plates, Slot Toasters, or Other Fire Hazards
- Halogen Lamps
- Alcohol
- Weapons (Including air pellet, soft pellet, water, paintball, or BB guns; swords;knives; etc.)

Miscellaneous

- _____
- _____
- _____
- _____
- _____
- _____
- _____
- _____
- _____
- _____

Housing Reminders:

- Complete the Residence Hall Application. Be sure that all the information you provide is accurate.
- Pay a housing fee of \$150. Your room fee must be received by the Business Office before you are assigned a room.
- *Move-in Day:* You will receive a room key & fill out a **Room Condition Form** at your assigned residence hall.
- **Remember:** Every effort will be made to accommodate each student's residential needs. There are some instances where a student will be allowed to change dorm rooms pending approval of the Hall Resident Director/Director of Student Affairs. Failure to follow proper check-out procedures will result in fees on the student's account. Fees for damage to dorm rooms and/or to residence hall bathrooms, hallways, lobby, etc. will be placed on the student's account when necessary. In cases where no one admits to having caused damage, a fee will be divided amongst all residents in the hall.

Hopefully, this general list will give you an idea of what you will need to set up your home here at Hiwassee. If you have any further questions, please let us know. We're always available to answer any questions or concerns you might have. We're looking forward to having you here at HC!

Tom Black & Allison Halls

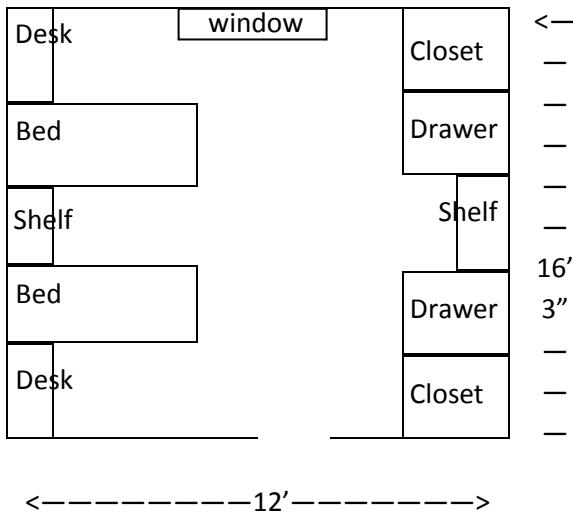

Window is 48" wide, 50.5" long

Brock Hall

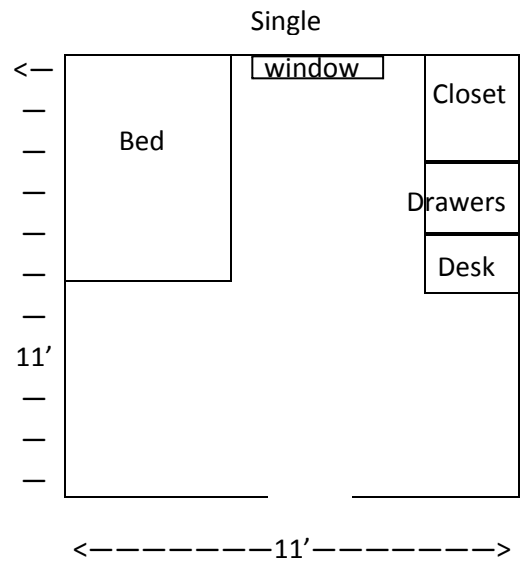
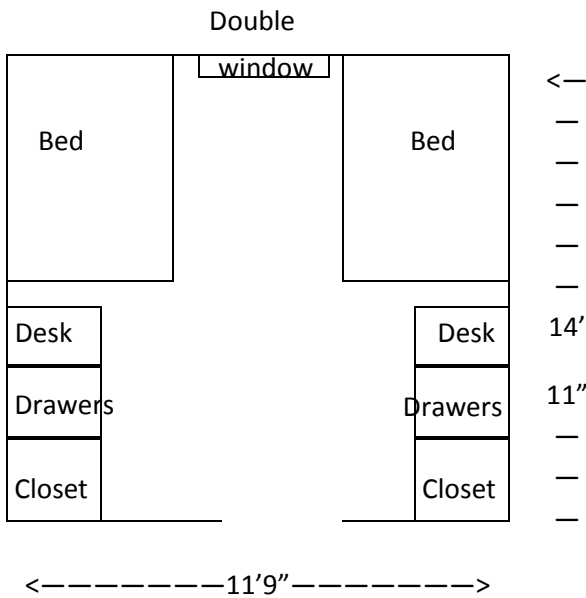

Window is 50.5" wide, 54" long.